



**BUILT FOR DURABILITY,
ADAPTABILITY, AND RELIABLE
PERFORMANCE**

omni brake®

OMNIBRAKE PULL-TO-LOCK

THE OMNIBRAKE PULL-TO-LOCK CHARACTERISTICS

Versatile Functionality

Originally designed as a tailgate lock for dump trucks, the chamber has expanded to applications such as drawbar lifts and clamping systems, showcasing its adaptability.

Corrosion Resistance

The chamber undergoes TSE's proprietary full immersion e-coating process, ensuring coverage and superior resistance to rust and wear.

Innovative Design

The patented pull-to-lock chamber features a fully sealed, all-steel housing with a chrome silicon pre-tempered spring for enhanced durability and longevity.

Flexible Configurations

Available in 2.5" and 3" stroke options with custom specifications upon request, meeting a variety of OEM application needs.

KEY BENEFITS FOR OEM SUPPLIERS

Reliable Performance

Backed by rigorous in-house testing and a standard 3-year warranty, ensuring consistent quality and dependability in demanding OEM environments.

Enhanced Durability

Rugged construction and advanced corrosion protection minimize long-term maintenance and reduce warranty claims.

Versatile Applications

A multi-functional design supports various use cases, providing flexibility and reducing the need for multiple specialized components.

Streamlined Production

Pre-assembled, ready-to-install units reduce production time and simplify integration into OEM manufacturing lines.

REMOTE PULL-TO-LOCK CHAMBER

OMNIBRAKE

30RPC2 & 30RPC3

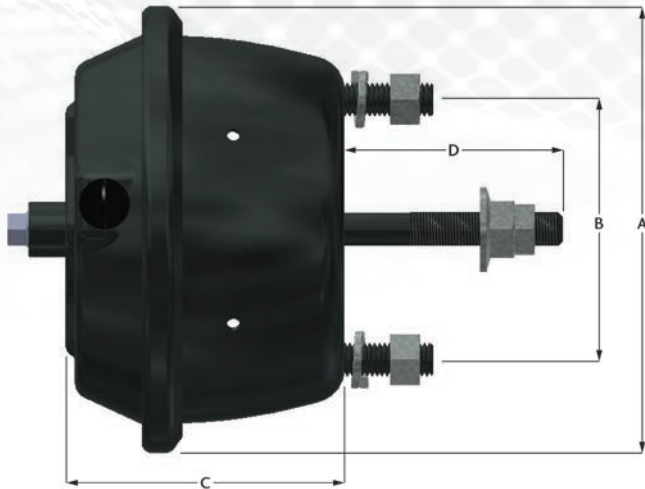

PART NUMBER	Stroke (in.)	Service Volume (in.3)	Weight (lbs)	A (in.)	B (in.)	C (in.)	D (in.)	Inlet Ports	Mounting Studs
30RPC2	2.50	92	12.7	8.1	4.75	5.1	Customer Specified	3/8-18 NPTF	5/8-11 UNC
30RPC3	3.00	110	12.9	8.1	4.75	5.1	Customer Specified	3/8-18 NPTF	5/8-11 UNC

30RPC2 (30SCL2R)
Chamber Performance

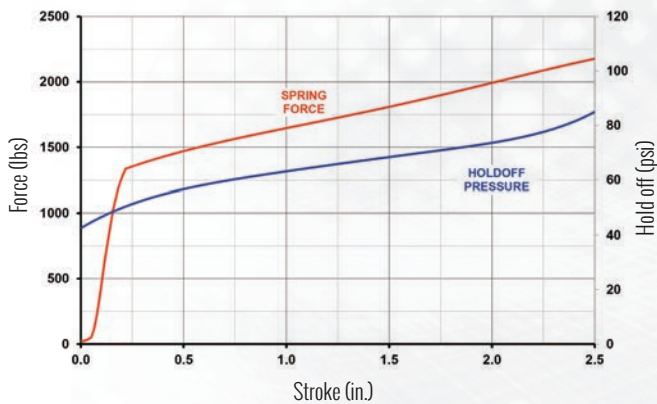

30RPC3 (30SCL3R)
Chamber Performance

